

HSF

TECHNICAL SPECS:

Current Rating: 3.0AMP
 Contact Resistance: 10mΩ Max
 Dielectric Strength: Min 1000VRMS
 Mechanical Life: Min 500 cycles
 Mating Pin: $\phi 0.40$ to $\phi 0.66$ mm or 0.50SQ
 Forces: (polished steel gauge $\phi 0.47$ mm)
 Insertion: 200g Max/Pin, Withdrawal: 60g/Pin
 Operation Temperature: -40°C to $+105^{\circ}\text{C}$

Sleeve: Brass CuZn36Pb3(C36000), Sn over Ni
 Contact Clip(4 finger): BeCu(C17200), Au or Sn over Ni
 Insulator Material: PPS+30%G.F(UL94V-0)

Ordering Information

3522-281 XX Z XX 074 X 1

No. of Pin 2~40PIN
 Contact Plating
 S0=Gold Flash/Tin
 S3=10u"Gold/Tin
 S4=15u"Gold/Tin
 S5=30u"Gold/Tin
 SN=Tin
 Packing
 A=Tray
 T=Tube
 P=Tube+Mylar
 R=Reel++Mylar

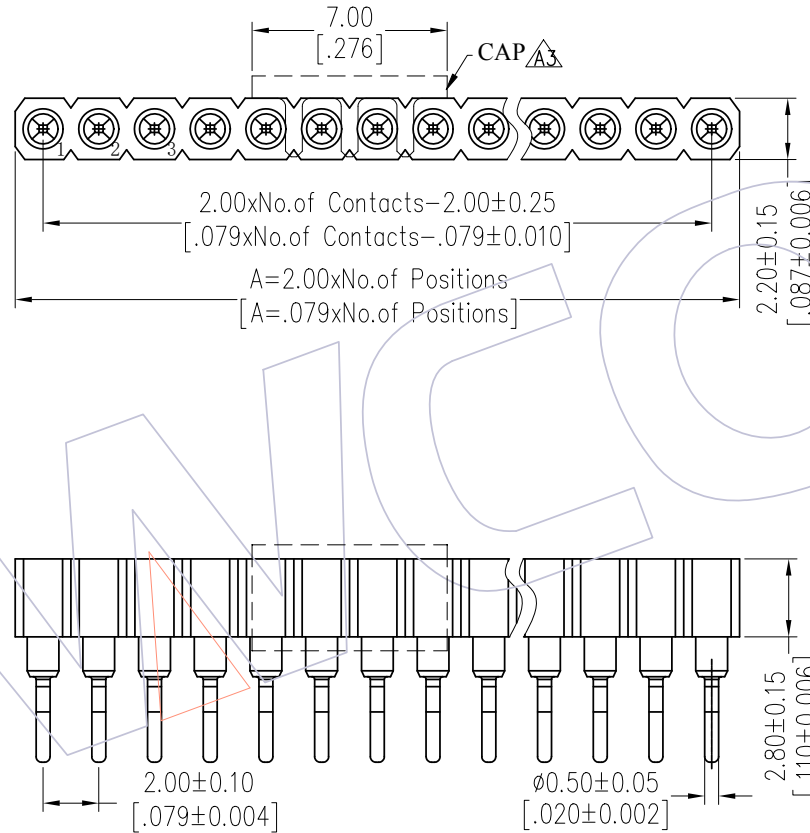

Recommended P.C.B Layout(Top Side)
 (PCB BOARD TOLERANCE ± 0.05)

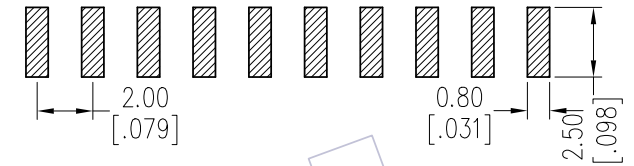

NO. of PIN	DIM A
40PIN	$2.0 \times \text{NO. of Positions} + 1.00 \pm 0.40$
<40PIN	$2.0 \times \text{NO. of Positions} \pm 0.60$

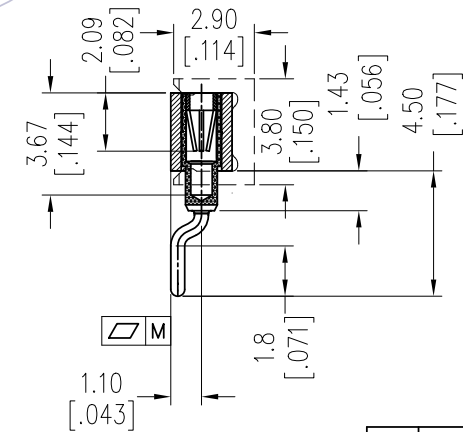
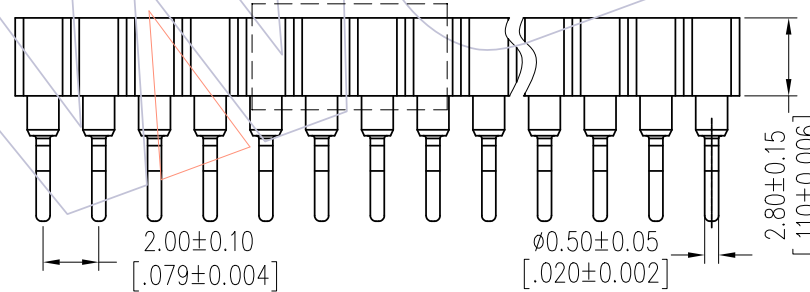

Item	Pitch	Mating
Standard	2.00	3512
Alternate		

PIN	2-10P	11-30P	31-40P
M	0.10	0.15	0.20

REV	DATE	MODIFICATION DESCRIPTION	CHANGE	DIM	TOL	OPERATION	DRAW	DATE	SCALE	FIT	PART NO.
A3	2018/10/29	Modify the Mylar to the CAP	-----			OPERATION	Ding	2018/10/29	UNIT	mm	3522-281XXZX074X1
A2	2017/10/19	Add the Mylar	-----	x.X	± 0.40		CHECK		SIZE	A4	TITLE: 2.00mm MACHINED FEMALE HEADER SINGLE ROW SMT H=2.80 L=7.4
A1	2013/05/17	Modify drawing	-----	x.XX	± 0.25		APPROVE		SHEET	1/1	Customer NO.
A0	2012/10/17	NEW	-----	x.XXX	± 0.15	Angle $\pm 3^{\circ}$			PROJ.		

WCON
 Http: www.wcon.com

WCON-Dongguan Tel: +86 769 85358920 Fax: +86 769 85358915 E-mail: sales@wcon.com

WCON-Kunshan Tel: +86 512 57468408 Fax: +86 512 57468468 E-mail: salesks@wcon.com