

# HSF

Notes:  
 Current rating: 0.5AMP  
 Oltage rating: 50V  
 Contact resistance: 100mΩ max  
 Withstand voltage: 250V AC  
 Insulation resistance: 500MΩ min  
 Operation temperature: -40℃ to +105℃  
 Contact material: copper alloy  
 Contact plating:  
 xu" gold on contact area (see ordering information)  
 Gold flash on solder area (ASTM B 488)  
 50u" nickel underplating overall (ASTM B 733)  
 Hold-down material: copper alloy  
 Hold-down plating:  
 100u" tin plating over all the pins.  
 50u" nickel underplating overall. (ASTM B 733)  
 Housing material: grass filled plastics; Black UL94V-0  
 Cap material: grass filled plastics; White UL94V-0  
 IR soldering, Peak temperature: 260±5℃, 5s ;

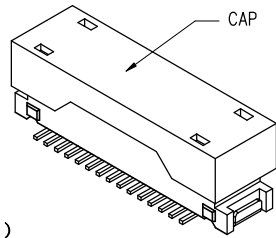

Recommended P.C.B layout (Top side)  
 (PCB board tolerance ±0.05)

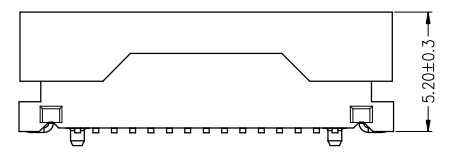
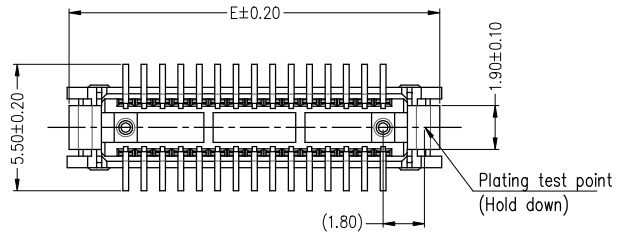
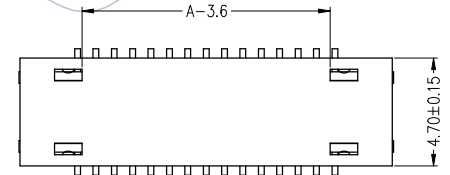
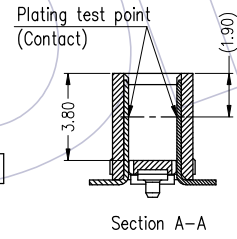
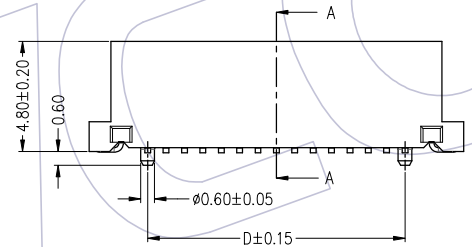
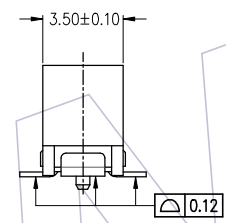
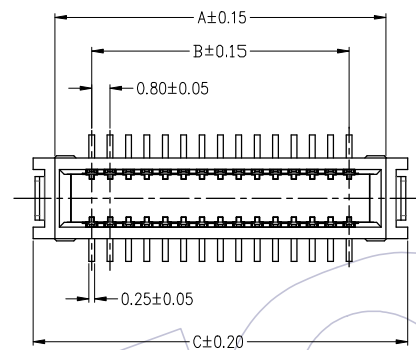
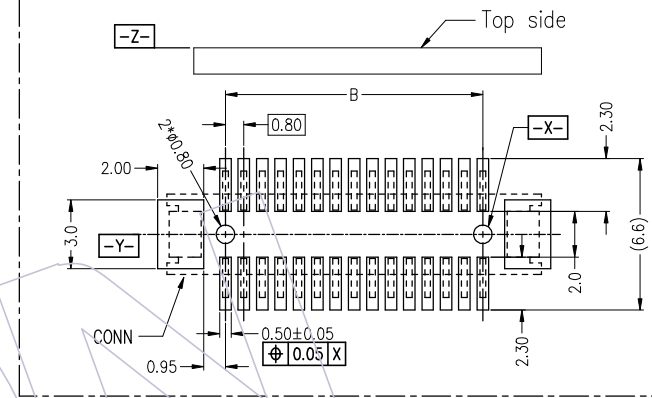

### Ordering Information

3618 - P XXX - XXX M XX R XX

No. of Pins:  
 030=30Pin  
 120=120Pin  
 (See Table 1)

Housing Height:  
 048=4.80mm  
 068=6.80mm  
 078=7.80mm

W/N Post:  
 01=With Post  
 02=Without Post

Packing:  
 R=Tape&Reel+CAP

Contact plating:  
 G1=3u" Gold  
 G2=5u" Gold  
 G3=10u" Gold  
 G4=15u" Gold  
 G5=30u" Gold

TABLE 1:

No. of Pins:	A	B	C	D	E
30	14.4	11.2	16.3	11.2	16.1
40	18.4	15.2	20.3	15.2	20.1
50	22.4	19.2	24.3	19.2	24.1
60	26.4	23.2	28.3	23.2	28.1
70	30.4	27.2	32.3	27.2	32.1
80	34.4	31.2	36.3	31.2	36.1

Rev	Date	Modification scription	Change	Operation	Draw	Date	Scale	FIT	Part No.
01	2022/06/24	NEW	-----	x.x ±0.40	XIAOBING YE	2022/06/24	Unit	mm	3618-PXXX-048MXXR01
				x.xx ±0.35	Check	Date	Size	A4	Title:
				x.xxx ±0.15	Approve	Date	Sheet	1/1	0.8mm Board To Board conn. PLUG SMT Type H=4.80mm With post
				Angle ± 3°			PROJ.	Customer No.	
				DIM TOL					

# WCON

Http: www.wcon.com

WCON-Dongguan  
 Tel: +86 769 85358920  
 Fax: +86 769 85358915  
 E-mail: sales@wcon.com

WCON-Kunshan  
 Tel: +86 512 57468408  
 Fax: +86 512 57468468  
 E-mail: salesks@wcon.com