

NOTES:  
 Current Rating:10A  
 Voltage Rating:300V  
 Contact Resistance:8milliohm Max  
 Withstand Voltage:AC2000V  
 Insulation Resistance:1000Megohm Min  
 Screw Torque: 4.4 lbf.in  
 Wire range: 12-30AWG  
 Operation Temperature:-40°C to +105°C

Housing Material:PA66 UL94V-0  
 Cover Material:PA66 UL94-V0  
 Screw:Steel  
 Pin Block:Brass  
 Contact:Phosphor Bronze

2P With 1 RAMP Locking "A"  $\Delta 3$

**Ordering Information:**

P F 508- A XX A SM N 1  $\Delta 5$  N  
 F=Female Pitch No. of Pins Contact Plated Blank=W/T WCON Logo  
 508=5.08 02-24P SM=Matte Tin N=W/O WCON Logo  
 Color Type  $\Delta 2$   
 A=Green N=W/O Two Side Screw

13P	66.04 ±0.30	60.96 ±0.30			
12P	60.96 ±0.30	55.88 ±0.30	24P	121.92 ±0.50	116.84 ±0.50
11P	55.88 ±0.30	50.80 ±0.30	23P	116.84 ±0.50	111.76 ±0.50
10P	50.80 ±0.30	45.72 ±0.30	22P	111.76 ±0.50	106.68 ±0.50
9P	45.72 ±0.30	40.64 ±0.30	21P	106.68 ±0.50	101.60 ±0.50
8P	40.64 ±0.30	35.56 ±0.30	20P	101.60 ±0.50	96.52 ±0.50
7P	35.56 ±0.20	30.48 ±0.20	19P	96.52 ±0.40	91.44 ±0.40
6P	30.48 ±0.20	25.40 ±0.20	18P	91.44 ±0.40	86.36 ±0.40
5P	25.40 ±0.20	20.32 ±0.20	17P	86.36 ±0.40	81.28 ±0.40
4P	20.32 ±0.20	15.24 ±0.20	16P	81.28 ±0.40	76.20 ±0.40
3P	15.24 ±0.20	10.16 ±0.20	15P	76.20 ±0.40	71.12 ±0.40
2P	10.16 ±0.20	5.08 ±0.10	14P	71.12 ±0.40	66.04 ±0.40
PIN	A	B	PIN	A	B

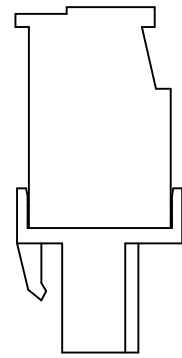

W/O WCON LOGO

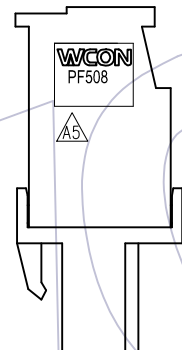

W/T WCON LOGO

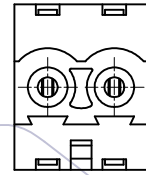
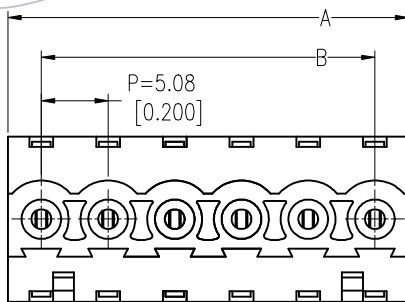
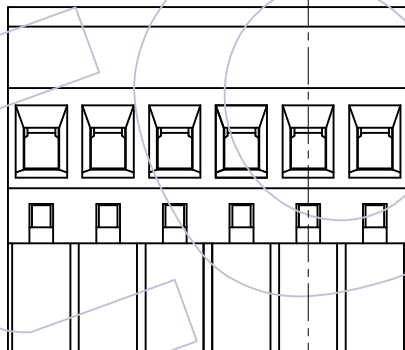
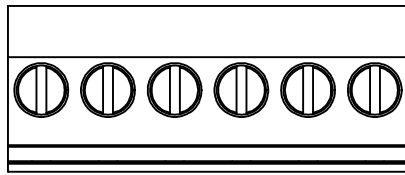

2 Pin

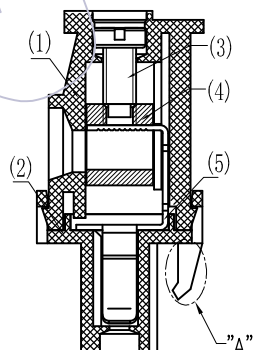
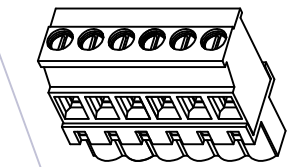
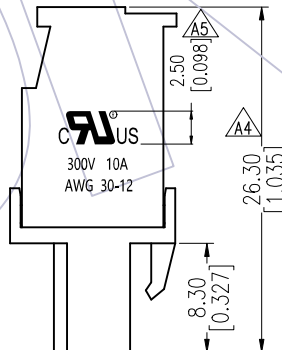

Section A-A

ITEM	品名	料号	数量	材料
(5)	Contact	TPT051-PSM001	N	C5191R-H T=0.4mm
(4)	Pin Block	BL025-1SNI01	N	C3604
(3)	Screw	MA025-1SXX01	N	C1018
(2)	Cover	XPF508-XXB1XN3	1	PA66 UL94-V0
(1)	Housing	XPF508-XXB1XN2(N)	1	PA66 UL94-V0

REV	DATE	MODIFICATION DESCRIPTION	CHANGE	OPERATION	DRAW	DATE	SCALE	FIT	PART NO.
A5	2020/12/23	ADD LOGO;ADD W/O LOGO P/N $\Delta 5$	XSR	OPERATION	DRAW	2020/12/23	UNIT	mm	PF508-AXXASMN1(N) $\Delta 5$
A4	2019/06/05	Modify 26.0 to 26.30 $\Delta 4$	XSR	x.X ±0.40	CHECK	DATE	SIZE	A4	TITLE: 5.08mm Pitch Female Pluggable Terminal Blocks
A3	2015/12/15	Modify $\Delta 3$	XSR	x.XX ±0.25	APPROVE	DATE	SHEET	1/1	Customer NO.
A0	2011/06/08	NEW		x.XXX ±0.15			PROJ.		
				Angle ± 3°					
				DIM TOL					

**WCON**  
 Http: www.wcon.com

WCON-Dongguan  
 Tel: +86 769 85358920  
 Fax: +86 769 85358915  
 E-mail: sales@wcon.com

WCON-Kunshan  
 Tel: +86 512 57468408  
 Fax: +86 512 57468468  
 E-mail: salesks@wcon.com