

# HSF

## NOTES:

- Current Rating: 33A(2PIN); 32A(3PIN); 32A(4PIN); 30A(6PIN)  
(10AWG, Ambient temperature: 25°C, Temperature rising: 80°C)
- Voltage Rating: 630V AC/DC;
- Contact Resistance: 3mΩ Max;
- Withstand Voltage: 3000V AC;
- Insulation Resistance: 1000MΩ Min;
- Operating Temperature: -40°C to +125°C;
- Insulator Material: PBT,G.F,UL94V-0,BK;
- Contact Material: Copper Alloy;
- Contact plating:  
W4: 15μ" Gold on contact area (See ordering information),  
100μ" Matte TIN on solder area,  
50μ" Nickel underplating overall;

## Ordering Information

WD10160-1 WS XX W4 B T O X X

- 1=Single Row
- WS=180°DIP
- No. of Pins:  
02=2P; 03=3P; 04=4P; 06=6P

Contact Plating:  
W4=15μ" Gold/Matte Sn

Color:

B=Black

T=Tube

0=Standard type

CODE OF KEYING

1=X; 2=Y

Blank=Without "WCON" Logo

W=With "WCON" Logo

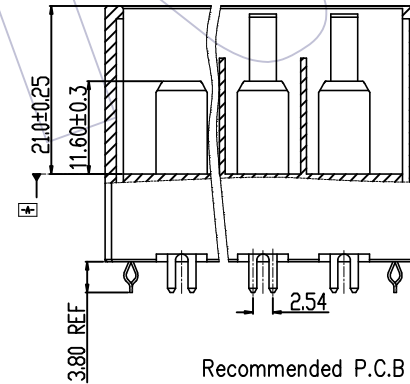
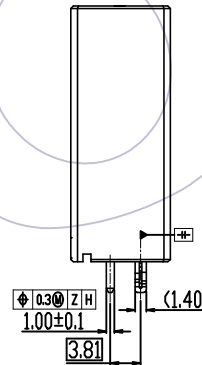
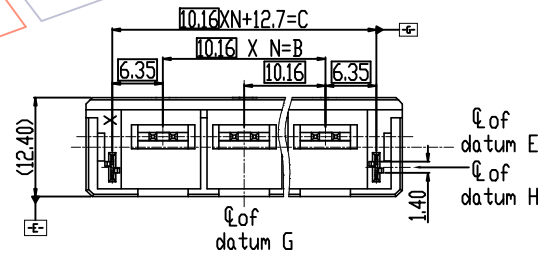
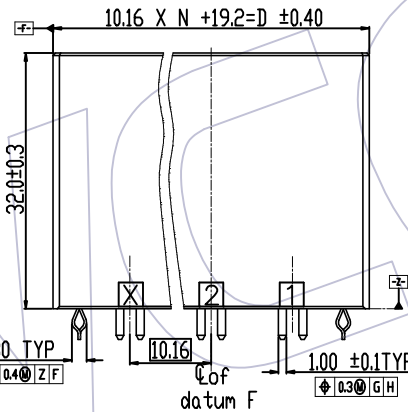
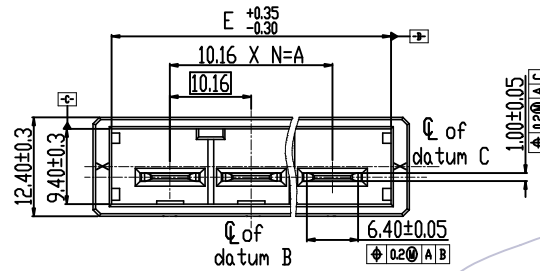

Recommended P.C.B Layout(Top Side)  
PCB THICKNESS: 1.6 ~ 2.4±0.1  
PCB Trace Thickness : More than 5oz  
(PCB BOARD TOLERANCE±0.05)

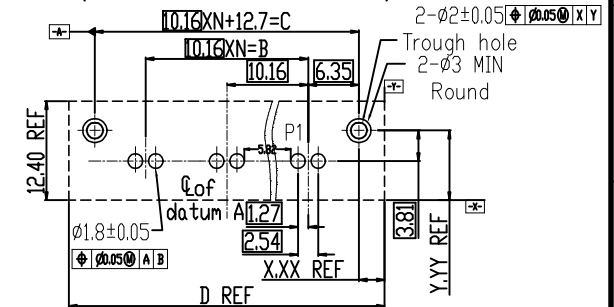

REV	DATE	MODIFICATION DESCRIPTION	CHANGE	OPERATION		DRAW shi chun	DATE 2022. 11. 27	SCALE UNIT	FIT mm	PART NO. WD10160-1WSXXW4BTOXX
				x.x	±0.40					
				x.xx	±0.25	CHECK	DATE	SIZE A4		TITLE: 10.16mm DYNAMIC Type Single Row Male 180° DIP
				x.xxx	±0.15	APPROVE	DATE	SHEET 1/3		Type
				Angle ± 3°	TOL			PROJ.	Customer NO.	

# WCON

Http: www.wcon.com

WCON-Dongguan Tel: +86 769 85358920 Fax: +86 769 85358915 E-mail: sales@wcon.com	WCON-Kunshan Tel: +86 512 57468408 Fax: +86 512 57468468 E-mail: salesks@wcon.com
---	--