

HSF

NOTES:

Rated Current: 1.5AMP. (20°C, 2*2P-2*15P)
 1.0AMP. (20°C, 2*16P-2*50P) $\triangle A2$
 Contact Resistance: 20m Ω Max.
 Withstand Voltage: 500V AC/DC
 Insulation Resistance: 1000M Ω Min.
 Operation Temperature: -40°C to +125°C (Gold Plating)
 -40°C to +105°C (Tin Plating) $\triangle A2$
 Contact Material: Copper Alloy
 Contact Plating: Au or Sn Over 30u" Min Ni $\triangle A2$
 Insulator Material: PA9T+G.F UL94V-0 BK $\triangle A2$

Ordering Information

1325-1 2 XX XX S XXX C X XX $\triangle A2$

Plastic Layer
 Plastic Row
 No. of Pins
 Per Row: 02~50
 Contact Plating
 G0=Gold Flash
 G3=10u"Au, BG3=8u"PdNi+2u"Au
 G4=15u"Au, BG4=13u"PdNi+2u"Au
 G5=30u"Au, BG5=28u"PdNi+2u"Au
 S0=Gold Flash/Tin
 S3=10u"Au/Sn, P3=8u"PdNi+2u"Au/Sn
 S4=15u"Au/Sn, P4=13u"PdNi+2u"Au/Sn
 S5=30u"Au/Sn, P5=28u"PdNi+2u"Au/Sn $\triangle A2$
 SN=Bright Tin
 SM=Matte Tin

Series No.
 01~99
 Packing
 A=Tray
 Insulator Material
 C=PA9T(Standard)
 Pin Length
 L(See Table)
 Type:
 S=S/T

Item	Pin Length	A	B	Mating
Standard	7.5	3.00	2.0	2321/2320T
	8.5		3.0	2334/2344/2346
	9.0		3.5	2357
	10.0		4.5	2345/2385
Standard	6.5	2.0 (THR)	2.0	2321/2320T
	7.5		3.0	2334/2344/2346
	8.0		3.5	2357
	9.0		4.5	2345/2385
Alternate				

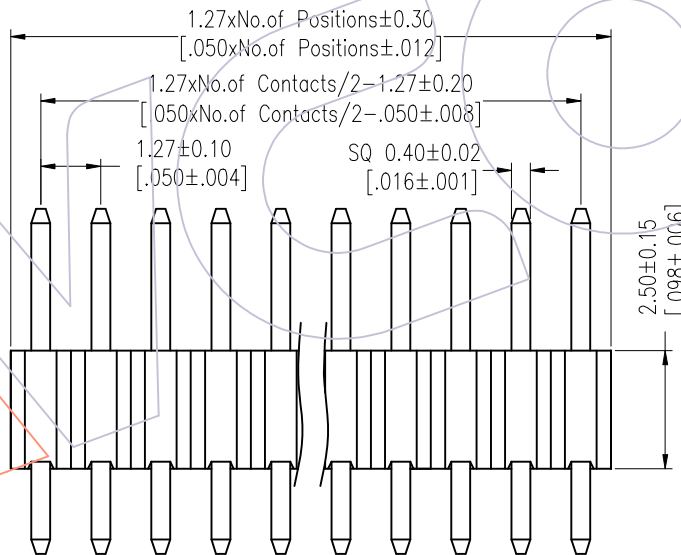
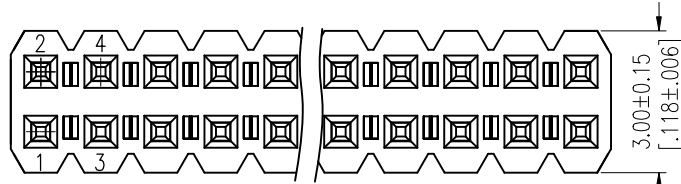

Recommended P.C.B Layout (Top Side)
 (PCB BOARD TOLERANCE±0.05)
 (PCB Thickness:T=1.60m)

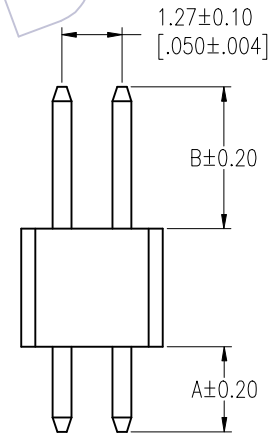
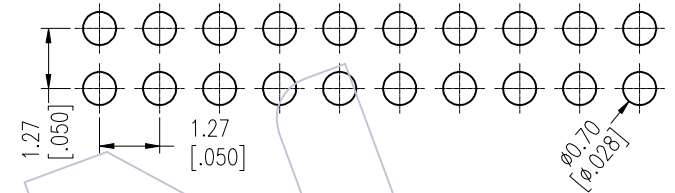

REV	DATE	MODIFICATION DESCRIPTION	CHANGE	OPERATION	DRAW	DATE	SCALE	Fit	PART NO.
A2	2025/09/04	Standardization Drawing	CP	x.X ±0.40	CP	2025/09/04	UNIT	mm [inch]	1325-12XXXXXXCXXX $\triangle A2$
A1	2018/01/18	MODIFY PART NO.	William Chen	x.XX ±0.25	CHECK	DATE	SIZE	A4	TITLE:
AO	2012/03/31	NEW	William Chen	x.XXX ±0.15	TANG	2025/09/04	SHEET	1/2	1.27 Pin Header, DUAL ROW, S/T, H=2.5
				Angle ± 3'	APPROVE	DATE	PROJ.		Customer NO.
				DIM TOL	Steven Zhao	2025/09/04			

WCON
 Http: www.wcon.com

WCON-Dongguan
 Tel: +86 769 85358920
 Fax: +86 769 85358915
 E-mail: sales@wcon.com

WCON-Kunshan
 Tel: +86 512 57468408
 Fax: +86 512 57468468
 E-mail: salesks@wcon.com

HSF

Packing:

Tray:

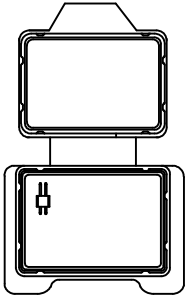

Tray

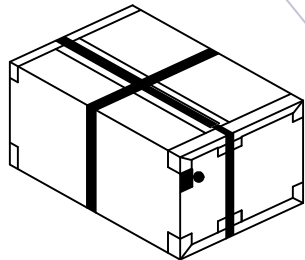

Box

Packaging Quantity Refers To The Following Table

PINS /Row	Q' ty/Tray (5.5<L≤8.5)	Q' ty/Box
1	1,000	48,000
2	1,000	48,000
3	1,000	48,000
4	1,000	48,000
5	800	38,400
6	800	38,400
7	500	24,000
8	500	24,000
9	500	24,000
10	500	24,000
11	300	14,400
12	300	14,400
13	200	9,600
14	200	9,600
15	200	9,600
16	200	9,600
17	200	9,600
18	200	9,600
19	200	9,600
20	200	9,600
21	200	9,600
22	200	9,600
23	200	9,600
24	200	9,600
25	200	9,600

PINS /Row	Q' ty/Tray (5.5<L≤8.5)	Q' ty/Box
26	200	9,600
27	200	9,600
28	200	9,600
29	200	9,600
30	200	9,600
31	200	9,600
32	200	9,600
33	200	9,600
34	130	6,240
35	150	7,200
36	150	7,200
37	150	7,200
38	100	4,800
39	100	4,800
40	100	4,800
41	100	4,800
42	100	4,800
43	100	4,800
44	100	4,800
45	100	4,800
46	100	4,800
47	100	4,800
48	100	4,800
49	100	4,800
50	100	4,800

PINS /Row	Q' ty/Tray (8.5<L<13.5)	Q' ty/Box
1	500	24,000
2	500	24,000
3	500	24,000
4	500	24,000
5	400	19,200
6	400	19,200
7	300	14,400
8	300	14,400
9	300	14,400
10	300	14,400
11	300	14,400
12	300	14,400
13	300	14,400
14	300	14,400
15	300	14,400
16	300	14,400
17	300	14,400
18	300	14,400
19	300	14,400
20	300	14,400
21	250	12,000
22	250	12,000
23	250	12,000
24	250	12,000
25	200	9,600

PINS /Row	Q' ty/Tray (8.5<L<13.5)	Q' ty/Box
26	250	12,000
27	250	12,000
28	250	12,000
29	250	12,000
30	200	9,600
31	200	9,600
32	200	9,600
33	200	9,600
34	200	9,600
35	200	9,600
36	100	4,800
37	100	4,800
38	100	4,800
39	100	4,800
40	100	4,800
41	100	4,800
42	100	4,800
43	100	4,800
44	100	4,800
45	100	4,800
46	100	4,800
47	100	4,800
48	100	4,800
49	100	4,800
50	100	4,800

REV	DATE	MODIFICATION DESCRIPTION	CHANGE	OPERATION	DRAW	DATE	SCALE	Fit	PART NO.	 Http: www.wcon.com WCON-Dongguan Tel: +86 769 85358920 WCON-Kunshan Tel: +86 512 57468408 Fax: +86 769 85358915 Fax: +86 512 57468468 E-mail: sales@wcon.com E-mail: salesks@wcon.com
A2	2025/09/04	Standardization Drawing	CP	x.X ±0.40	CP	2025/09/04	UNIT	mm [inch]	1325-12XXXXXXCXXX 	
A1	2018/01/18	MODIFY PART NO.	William Chen	x.xx ±0.25	CHECK	2025/09/04	SIZE	A4	TITLE: 1.27 Pin Header, DUAL ROW, S/T, H=2.5	
AO	2012/03/31	NEW	William Chen	x.xxx ±0.15	TANG	2025/09/04	SHEET	2/2	Customer NO.	
				Angle ± 3'	APPROVE	2025/09/04	PROJ.			
				DIM TOL	Steven Zhao					