

HSF

NOTES:

Rated Current: 5.0AMP.(20°C, 2*2P-2*15P)
 3.0AMP.(20°C, 2*16P-2*40P) $\triangle A5$
 Contact Resistance: 20m Ω Max.
 Withstand Voltage: 1000V AC/DC
 Insulation Resistance: 1000M Ω Min.
 Operation Temperature: -40°C to +125°C (Gold Plating)
 -40°C to +105°C (Tin Plating) $\triangle A5$
 Contact Material: Copper Alloy
 Contact Plating: Au or Sn Over 30u" Min Ni $\triangle A5$
 Insulator Material: PA9T+G.F UL94V-0 BK $\triangle A5$

Ordering Information

1117- 1 2 XX XX M XXX C X XX $\triangle A3$

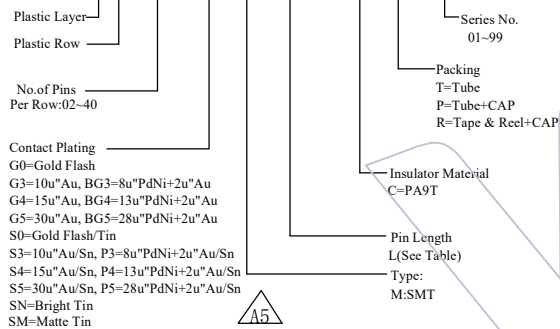

Item	Pin Length	W	D	E	B	Mating
Standard	8.0	7.37	0.6	2.94	3.5	2135/2150T/2157
	8.5				4.0	2145/2150
	9.5				5.0	2168T/2171T
	10.5				5.84	2171/2185X
Alternate						

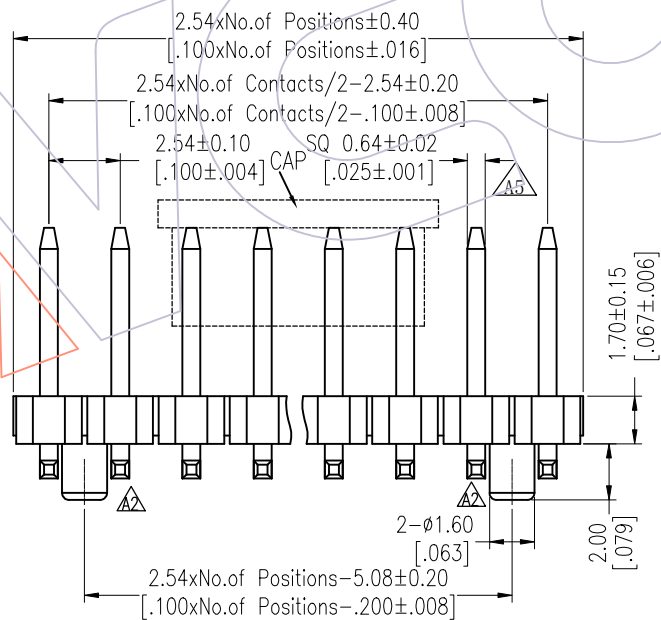
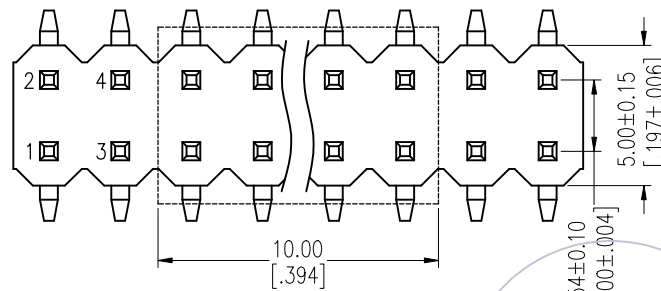

Recommended P.C.B Layout (Top Side)

(PCB BOARD TOLERANCE ±0.05)
 (PCB Thickness: T=1.60m)

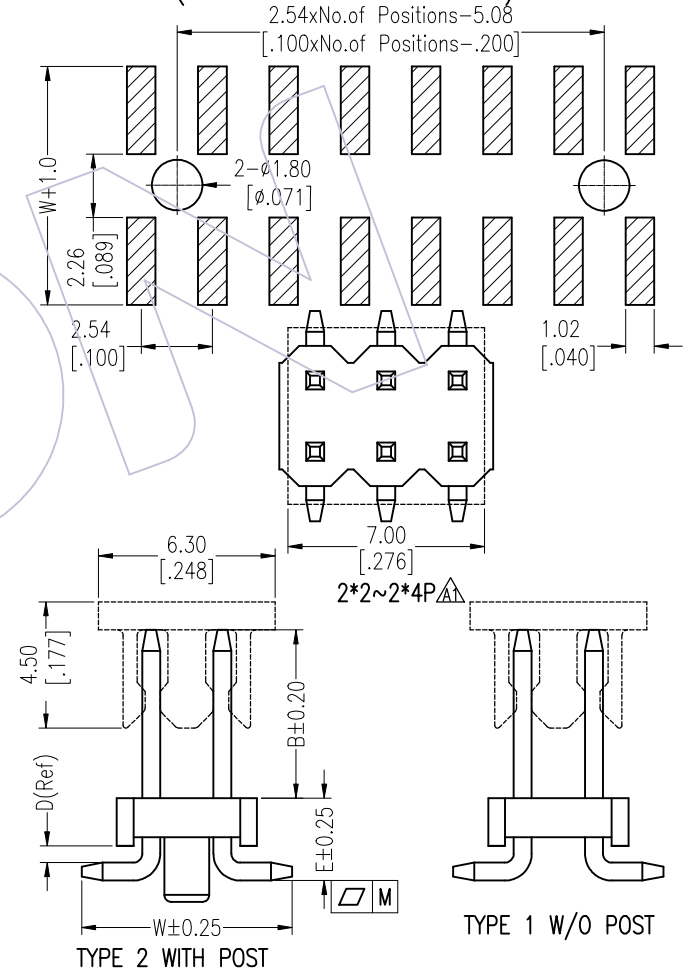

PIN(PerRow)	2-15P	16-25P	26-40P
M	0.10	0.15	0.20

REV	DATE	MODIFICATION DESCRIPTION	CHANGE	DIM	TOL	APPROVE	DATE	PROJ.	PART NO.	TITLE:
A5	2025/03/17	Standardization Drawing	CP	OPERATION		DRAW	DATE	SCALE	Fit	1117-12XXXXMXXXCXXX
A4	2023/02/03	Add Flatness	Du Ying	X.X ±0.40		CP	2025/03/17	UNIT	mm [inch]	
A3	2018/01/22	Modify P/N	Ruipeng	X.XX ±0.25		CHECK	DATE	SIZE	A4	
A0	2012/05/04	NEW	Ruipeng	X.XXX ±0.15		TANG	2025/03/17	SHEET	1/4	
REV	DATE	MODIFICATION DESCRIPTION	CHANGE	DIM	TOL	APPROVE	DATE	PROJ.	Customer NO.	
						Steven Zhao	2025/03/17			

WCON
[Http://www.wcon.com](http://www.wcon.com)

WCON-Dongguan
 Tel: +86 769 85358920
 Fax: +86 769 85358915
 E-mail: sales@wcon.com

WCON-Kunshan
 Tel: +86 512 57468408
 Fax: +86 512 57468468
 E-mail: salesks@wcon.com

HSF

Packing:

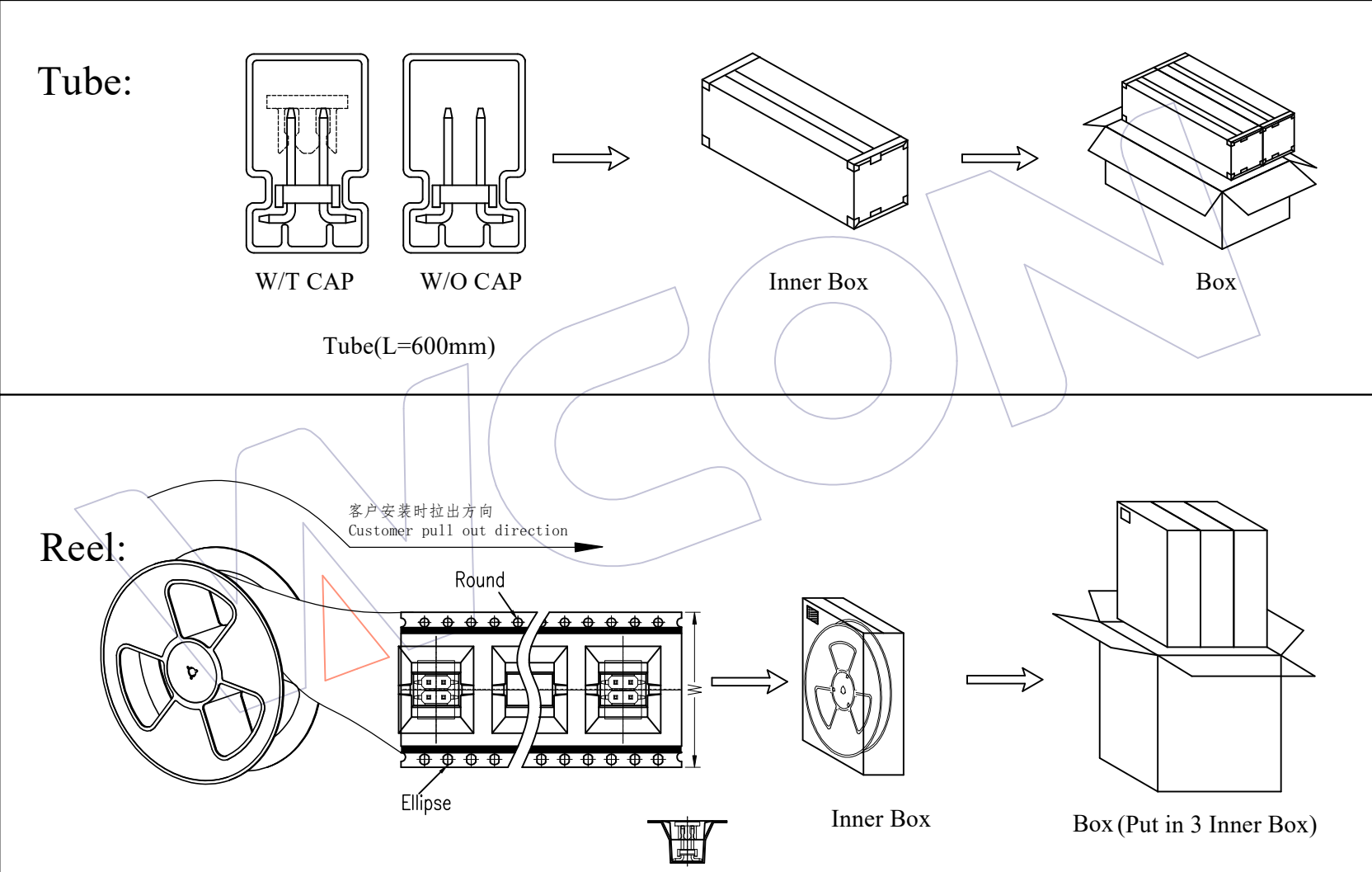

A5	2025/03/17	Standardization Drawing	CP	OPERATION	DRAW	DATE	SCALE	Fit	PART NO.
A4	2023/02/03	Add Flatness	Du Ying	x.X ±0.40	CP	2025/03/17	UNIT	mm [inch]	1117-12XXXXMXXCRXX
A3	2018/01/22	Modify P/N	Ruipeng	x.xx ±0.25	CHECK	DATE	SIZE	A4	TITLE:
A0	2012/05/04	NEW	Ruipeng	x.xxx ±0.15	TANG	2025/03/17	SHEET	2/4	PH2.54 DUAL ROW SMT H=1.7
REV	DATE	MODIFICATION DESCRIPTION	CHANGE	Angle ± 3'	APPROVE	DATE	PROJ.	Customer NO.	
				DIM TOL	Steven Zhao	2025/03/17			

WCON
[Http: www.wcon.com](http://www.wcon.com)
 WCON-Dongguan Tel: +86 769 85358920 Fax: +86 769 85358915 E-mail: sales@wcon.com
 WCON-Kunshan Tel: +86 512 57468408 Fax: +86 512 57468468 E-mail: salesks@wcon.com

HSF

Packaging Quantity Refers To The Following Table

B=3.5

B=4.0

PINS /Row	Q' ty/Tube	Q' ty/Inner Box	Q' ty/Box	PINS /Row	Q' ty/Tube	Q' ty/Inner Box	Q' ty/Box
4	54	6,480	12,960	23	9	1,080	2,160
5	45	5,400	10,800	24	9	1,080	2,160
6	38	4,560	9,120	25	9	1,080	2,160
7	31	3,720	7,440	26	8	960	1,920
8	27	3,240	6,480	27	8	960	1,920
9	24	2,880	5,760	28	8	960	1,920
10	22	2,640	5,280	29	7	840	1,680
11	20	2,400	4,800	30	7	840	1,680
12	18	2,160	4,320	31	7	840	1,680
13	17	2,040	4,080	32	7	840	1,680
14	16	1,920	3,840	33	6	720	1,440
15	15	1,800	3,600	34	6	720	1,440
16	14	1,680	3,360	35	6	720	1,440
17	13	1,560	3,120	36	6	720	1,440
18	12	1,440	2,880	37	6	720	1,440
19	11	1,320	2,640	38	5	600	1,200
20	11	1,320	2,640	39	5	600	1,200
21	10	1,200	2,400	40	5	600	1,200
22	10	1,200	2,400				

PINS /Row	W	Q' ty/Reel	Q' ty/Inner Box	Q' ty/Box	PINS /Row	W	Q' ty/Reel	Q' ty/Inner Box	Q' ty/Box
2	24	460	1,380	4,140	2	24	420	1,260	3,780
3	24	460	1,380	4,140	3	24	420	1,260	3,780
4	24	460	1,380	4,140	4	24	420	1,260	3,780
5	24	460	1,380	4,140	5	32	420	840	2,520
6	32	460	920	2,760	6	32	420	840	2,520
7	44	460	920	2,760	7	44	420	840	2,520
8	44	460	920	2,760	8	44	420	840	2,520
9	44	460	920	2,760	9	44	420	840	2,520
10	44	460	920	2,760	10	44	420	840	2,520
11	44	460	920	2,760	11	44	420	840	2,520
12	56	460	460	1,380	12	56	420	420	1,260
13	56	460	460	1,380	13	56	420	420	1,260
14	56	460	460	1,380	14	56	420	420	1,260
15	56	460	460	1,380	15	56	420	420	1,260
16	56	460	460	1,380	16	72	420	420	1,260
17	72	460	460	1,380	17	72	420	420	1,260
18	72	460	460	1,380	18	72	420	420	1,260
19	72	460	460	1,380	19	72	420	420	1,260
20	72	460	460	1,380	20	72	420	420	1,260
21	72	460	460	1,380	21	72	420	420	1,260
22	72	460	460	1,380	22	72	420	420	1,260
23	88	460	460	1,380	23	88	420	420	1,260
24	88	460	460	1,380	24	88	420	420	1,260
25	88	460	460	1,380	25	88	420	420	1,260
26	88	460	460	1,380	26	88	420	420	1,260
27	88	460	460	1,380	27	88	420	420	1,260

A5	2025/03/17	Standardization Drawing	CP	OPERATION	DRAW	DATE	SCALE	Fit	PART NO.	 http://www.wcon.com WCON-Dongguan Tel: +86 769 85358920 WCON-Kunshan Tel: +86 512 57468408 Fax: +86 769 85358915 Fax: +86 512 57468468 E-mail: sales@wcon.com E-mail: sales@wcon.com
A4	2023/02/03	Add Flatness	Du Ying	x.X ±0.40	CP	2025/03/17	UNIT	mm [inch]	TITLE:	
A3	2018/01/22	Modify P/N	Ruipeng	x.xx ±0.25	CHECK	DATE	SIZE	A4	PH2.54 DUAL ROW SMT H=1.7	
A0	2012/05/04	NEW	Ruipeng	x.xxx ±0.15	TANG	2025/03/17	SHEET	3/4	Customer NO.	
REV	DATE	MODIFICATION DESCRIPTION	CHANGE	Angle ± 3'	APPROVE	DATE	PROJ.	⊕		
				DIM TOL	Steven Zhao	2025/03/17				

HSF

Packaging Quantity Refers To The Following Table

B=5.0

PINS /Row	W	Q' ty/Reel	Q' ty/Inner Box	Q' ty/Box
2	24	380	1,140	3,420
3	24	380	1,140	3,420
4	24	380	1,140	3,420
5	32	380	760	2,280
6	32	380	760	2,280
7	44	380	760	2,280
8	44	380	760	2,280
9	44	380	760	2,280
10	44	380	760	2,280
11	56	380	380	1,140
12	56	380	380	1,140
13	56	380	380	1,140
14	56	380	380	1,140
15	56	380	380	1,140
16	72	380	380	1,140
17	72	380	380	1,140
18	72	380	380	1,140
19	72	380	380	1,140
20	72	380	380	1,140
21	72	380	380	1,140
22	88	380	380	1,140
23	88	380	380	1,140
24	88	380	380	1,140
25	88	380	380	1,140
26	88	380	380	1,140
27	88	380	380	1,140

B=5.84

PINS /Row	W	Q' ty/Reel	Q' ty/Inner Box	Q' ty/Box
2	24	300	900	2,700
3	24	300	900	2,700
4	24	300	900	2,700
5	32	300	600	1,800
6	44	300	600	1,800
7	44	300	600	1,800
8	44	300	600	1,800
9	44	300	600	1,800
10	44	300	600	1,800
11	56	300	300	900
12	56	300	300	900
13	56	300	300	900
14	56	300	300	900
15	72	300	300	900
16	72	300	300	900
17	72	300	300	900
18	72	300	300	900
19	72	300	300	900
20	72	300	300	900
21	72	300	300	900
22	88	300	300	900
23	88	300	300	900
24	88	300	300	900
25	88	300	300	900
26	88	300	300	900
27	88	300	300	900

A5	2025/03/17	Standardization Drawing	CP	OPERATION	DRAW	DATE	SCALE	Fit	PART NO.
A4	2023/02/03	Add Flatness	Du Ying	x.x ±0.40	CP	2025/03/17	UNIT	mm [inch]	1117-12XXXXMXXCRXX
A3	2018/01/22	Modify P/N	Ruipeng	x.xx ±0.25	CHECK	DATE	SIZE	A4	TITLE:
A0	2012/05/04	NEW	Ruipeng	x.xxx ±0.15	TANG	2025/03/17	SHEET	4/4	PH2.54 DUAL ROW SMT H=1.7
REV	DATE	MODIFICATION DESCRIPTION	CHANGE	Angle ± 3'	APPROVE	DATE	PROJ.	Customer NO.	
				DIM TOL	Steven Zhao	2025/03/17			

WCON
[Http: www.wcon.com](http://www.wcon.com)
 WCON-Dongguan Tel: +86 769 85358920
 WCON-Kunshan Tel: +86 512 57468408
 Fax: +86 769 85358915 Fax: +86 512 57468468
 E-mail: sales@wcon.com E-mail: salesks@wcon.com