

HSF

NOTES:

Rated Current: 5.0AMP.(20°C,1*2P-1*10P)

3.0AMP.(20°C,1*11P-1*40P) $\triangle A3$

Contact Resistance: 20m Ω Max.

Withstand Voltage: 1000V AC/DC

Insulation Resistance: 1000M Ω Min.

Operation Temperature: -40°C to +125°C(Gold Plating)

-40°C to +105°C(Tin Plating) $\triangle A3$

Contact Material: Copper Alloy

Contact Plating: Au or Sn Over 30u" Min Ni $\triangle A3$ $\triangle A2$

Insulator Material: PA9T+G.F UL94V-0 BK $\triangle A3$ $\triangle A2$

Ordering Information

1125- 2 1 XX XX R XXX C X XX

Plastic Layer
Plastic Row
No. of Pins
Per Row: 02~40

Contact Plating
G0=Gold Flash
G3=10u"Au, BG3=8u"PdNi+2u"Au
G4=15u"Au, BG4=13u"PdNi+2u"Au
G5=30u"Au, BG5=28u"PdNi+2u"Au
S0=Gold Flash/Tin
S3=10u"Au/Sn, P3=8u"PdNi+2u"Au/Sn
S4=15u"Au/Sn, P4=13u"PdNi+2u"Au/Sn
S5=30u"Au/Sn, P5=28u"PdNi+2u"Au/Sn
SN=Bright Tin
SM=Matte Tin $\triangle A3$

Series No.
01~99
Packing
0=PE Bag
Insulator Material
C=PA9T
Pin Length
See Table 1
Type:
R:R/A

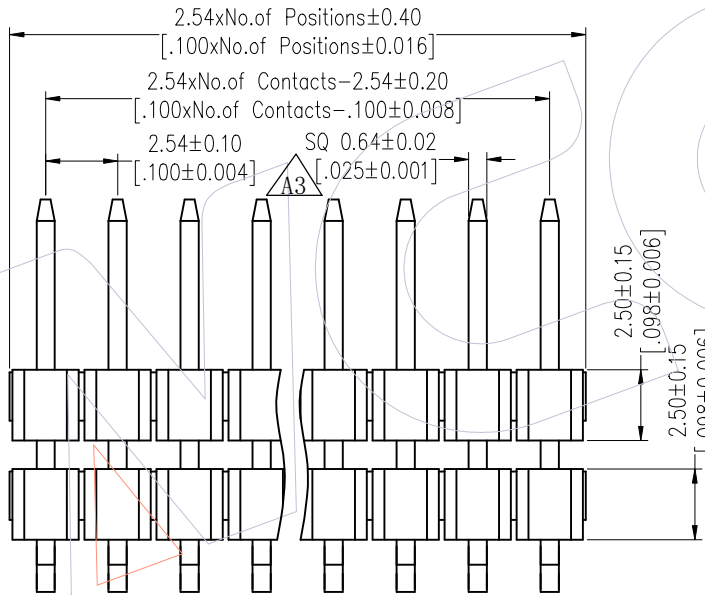
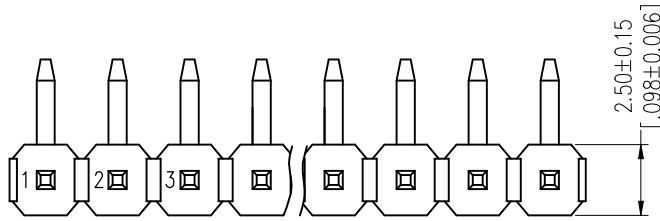

Recommended P.C.B Layout (Top Side)
(PCB BOARD TOLERANCE±0.05)
(PCB Thickness:T=1.60m)

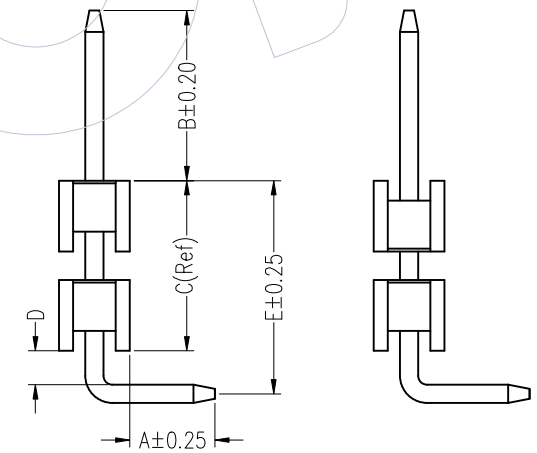
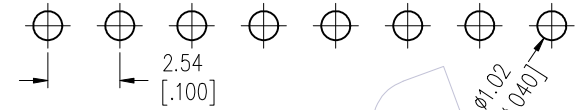

TYPE 1

TYPE 2

A3	2025/06/07	Standardization Drawing	CP	OPERATION	DRAW	DATE	SCALE	Fit	PART NO. 1125-21XXXXXXXCXXX $\triangle A1$ $\triangle A2$
A2	2018/06/02	Cancel PBT & Modify P/N	XSR	x.X ±0.40	CP	2025/06/07	UNIT	mm	
A1	2018/01/22	Modify P/N	Ruipeng	x.XX ±0.25	CHECK	DATE	SIZE	A4	TITLE: PH2.54 SINGLE ROW DOUBLE PLASTIC 90° CONCAVE BENDING H=2.5
A0	2012/05/17	NEW	William Chen	x.XXX ±0.15	TANG	2025/06/07	SHEET	1/3	
REV	DATE	MODIFICATION DESCRIPTION	CHANGE	Angle ± 3°	APPROVE	DATE	PROJ.		Customer NO.
				DIM TOL	Steven Zhao	2025/06/07			

WCON

Http: www.wcon.com

WCON-Dongguan
Tel: +86 769 85358920
Fax: +86 769 85358915
E-mail: sales@wcon.com

WCON-Kunshan
Tel: +86 512 57468408
Fax: +86 512 57468468
E-mail: salesks@wcon.com

HSF

Table 1

Item	L	E	C	D	A	B	Mating
Standard	16.3	8.72	7.7	0.7	3.0	3.5	2135/2150T/2157
	16.8					4.0	2145/2150
	17.8					5.0	2168T/2171T
	18.5					5.84	2171/2185X
	20.5	13.22	12.2	0.7		3.5	2135/2150T/2157
	21.2					4.0	2145/2150
	22.2					5.0	2168T/2171T
	23.0					5.84	2171/2185X
	19.2	11.81	10.54	0.95		3.5	2135/2150T/2157
	19.8					4.0	2145/2150
	20.8					5.0	2168T/2171T
	21.5					5.84	2171/2185X
	24.8	17.4	15.88	1.2		3.5	2135/2150T/2157
	25.3					4.0	2145/2150
26.5	5.0				2168T/2171T		
27.0	5.84				2171/2185X		
Standard	15.3	8.72	7.7	0.7	2.0 (THR)	3.5	2135/2150T/2157
	15.8					4.0	2145/2150
	16.8					5.0	2168T/2171T
	17.5					5.84	2171/2185X
	19.5	13.22	12.2	0.7		3.5	2135/2150T/2157
	20.3					4.0	2145/2150
	21.2					5.0	2168T/2171T
	22.0					5.84	2171/2185X
	18.2	11.81	10.54	0.95		3.5	2135/2150T/2157
	18.8					4.0	2145/2150
	19.8					5.0	2168T/2171T
	20.5					5.84	2171/2185X
	23.8	17.4	15.88	1.2		3.5	2135/2150T/2157
	24.3					4.0	2145/2150
25.5	5.0				2168T/2171T		
26.0	5.84				2171/2185X		
Alternate							

Packing:

Packaging Quantity Refers To The Following Table

PE Bag:

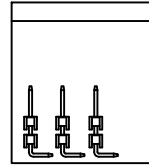

PE Bag

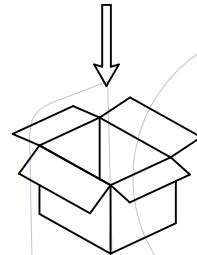

Inner Box

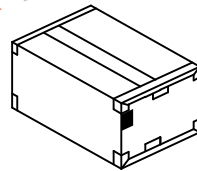

Box

PINS	Q' ty/Bag (10.0 < L ≤ 16.0)	PINS	Q' ty/Bag (10.0 < L ≤ 16.0)
1	1,000	21	200
2	1,000	22	200
3	1,000	23	200
4	1,000	24	200
5	1,000	25	200
6	1,000	26	200
7	1,000	27	200
8	1,000	28	200
9	500	29	200
10	500	30	200
11	500	31	200
12	500	32	200
13	500	33	200
14	500	34	200
15	300	35	200
16	300	36	200
17	300	37	200
18	300	38	200
19	300	39	150
20	200	40	150

A3	2025/06/07	Standardization Drawing	CP	OPERATION	DRAW	DATE	SCALE	Fit	PART NO.
A2	2018/06/02	Cancel PBT & Modify P/N	XSR	x.X ±0.40	CP	2025/06/07	UNIT	mm	1125-21XXXXXXXCXXX A1 A2
A1	2018/01/22	Modify P/N	Ruipeng	x.xx ±0.25	CHECK	DATE	SIZE	A4	TITLE:
A0	2012/05/17	NEW	William Chen	x.xxx ±0.15	TANG	2025/06/07	SHEET	2/3	PH2.54 SINGLE ROW DOUBLE PLASTIC 90° CONCAVE BENDING H=2.5
REV	DATE	MODIFICATION DESCRIPTION	CHANGE	Angle ± 3°	APPROVE	DATE	PROJ.	Customer NO.	
				DIM TOL	Steven Zhao	2025/06/07			

WCON

Http: www.wcon.com

WCON-Dongguan Tel: +86 769 85358920 Fax: +86 769 85358915 E-mail: sales@wcon.com	WCON-Kunshan Tel: +86 512 57468408 Fax: +86 512 57468468 E-mail: salesks@wcon.com
---	--

HSF

Packaging Quantity Refers To The Following Table

PINS	Q' ty/Bag (16.0<L≤19.0)	PINS	Q' ty/Bag (16.0<L≤19.0)	PINS	Q' ty/Bag (19.0<L≤30.0)	PINS	Q' ty/Bag (19.0<L≤30.0)
1	1,000	21	100	1	500	21	100
2	1,000	22	100	2	500	22	100
3	800	23	100	3	500	23	100
4	800	24	100	4	500	24	100
5	800	25	100	5	500	25	100
6	500	26	100	6	300	26	50
7	500	27	100	7	300	27	50
8	500	28	100	8	300	28	50
9	500	29	100	9	300	29	50
10	300	30	100	10	300	30	50
11	300	31	100	11	300	31	50
12	300	32	100	12	200	32	50
13	300	33	100	13	200	33	50
14	200	34	100	14	200	34	50
15	200	35	100	15	200	35	50
16	200	36	100	16	100	36	50
17	200	37	100	17	100	37	50
18	200	38	100	18	100	38	50
19	200	39	100	19	100	39	50
20	100	40	100	20	100	40	50

A3	2025/06/07	Standardization Drawing	CP	OPERATION	DRAW	DATE	SCALE	Fit	PART NO. 1125-21XXXXRXXXCXXX
A2	2018/06/02	Cancel PBT & Modify P/N	XSR	x.X ±0.40	CP	2025/06/07	UNIT	mm	
A1	2018/01/22	Modify P/N	Ruipeng	x.XX ±0.25	CHECK	DATE	SIZE	A4	TITLE: PH2.54 SINGLE ROW DOUBLE PLASTIC 90° CONCAVE BENDING H=2.5
A0	2012/05/17	NEW	William Chen	x.XXX ±0.15	TANG	2025/06/07	SHEET	3/3	
REV	DATE	MODIFICATION DESCRIPTION	CHANGE	Angle ± 3°	APPROVE	DATE	PROJ.	Customer NO.	
				DIM TOL	Steven Zhao	2025/06/07			

WCON
 Http: www.wcon.com
 WCON-Dongguan Tel: +86 769 85358920
 WCON-Kunshan Tel: +86 512 57468408
 Fax: +86 769 85358915 Fax: +86 512 57468468
 E-mail: sales@wcon.com E-mail: salesks@wcon.com