

HSF

NOTES:

Rated Current: 5.0AMP.(20°C,1*2P-1*10P)
3.0AMP.(20°C,1*11P-1*40P)

Contact Resistance: 20mΩ Max.
Withstand Voltage: 1000V AC/DC
Insulation Resistance: 1000MΩ Min.

Operation Temperature: -40°C to +125°C(Gold Plating)
-40°C to +105°C(Tin Plating)

Contact Material: Copper Alloy
Contact Plating: Au or Sn Over 30u" Min Ni
Insulator Material: PA9T+G.F UL94V-0 BK

Ordering Information

1125-2 1 XX XX R XXX C X XX

Plastic Layer
Plastic Row
No. of Pins Per Row: 02-40
Contact Plating
G0=Gold Flash
G3=10u"Au, BG3=8u"PdNi+2u"Au
G4=15u"Au, BG4=13u"PdNi+2u"Au
G5=30u"Au, BG5=28u"PdNi+2u"Au
S0=Gold Flash/Tin
S3=10u"Au/Sn, P3=8u"PdNi+2u"Au/Sn
S4=15u"Au/Sn, P4=13u"PdNi+2u"Au/Sn
S5=30u"Au/Sn, P5=28u"PdNi+2u"Au/Sn
SN=Bright Tin
SM=Matte Tin

Series No. 01-99
Packing 0=PE Bag
Insulator Material C=PA9T
Pin Length
Type: R:R/A

Item	L	A	B	D1	D2	Mating
Standard	17.3	3.0	3.5	3.0	2.5	2135/2150T/2157
	17.8		4.0			2145/2150
	18.8		5.0			2168T/2171T
	19.8		5.84			2171/2185X
Standard	16.3	2.0 (THR)	3.5	3.0	2.5	2135/2150T/2157
	16.8		4.0			2145/2150
	17.8		5.0			2168T/2171T
	18.8		5.84			2171/2185X
Alternate						

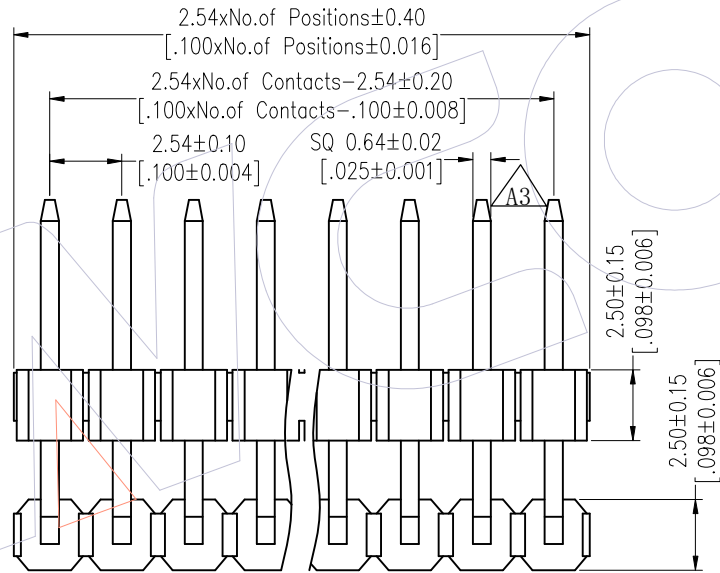
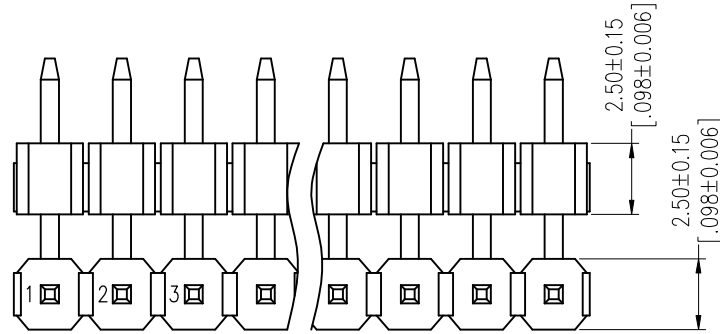

Recommended P.C.B Layout (Top Side)
(PCB BOARD TOLERANCE±0.05)
(PCB Thickness:T=1.60m)

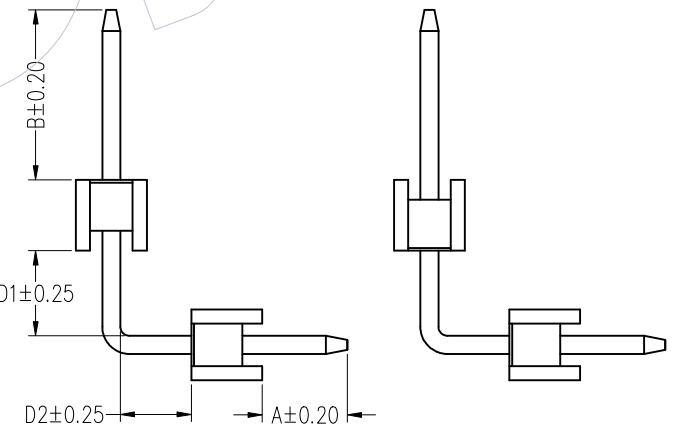
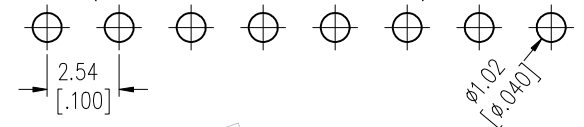

TYPE 3

TYPE 4

A3	2025/06/12	Standardization Drawing	CP	OPERATION	DRAW	DATE	SCALE	Fit	PART NO.
A3	2025/03/18	Modify	DuYing	x.X ±0.40	CP	2025/06/12	UNIT	mm	1125-21XXXXXXXCXXX
A2	2018/06/02	Cancel PBT & Modify P/N	XSR	x.XX ±0.25	CHECK	DATE	SIZE	A4	TITLE:
A0	2012/05/17	NEW	William Chen	x.XXX ±0.15	TANG	2025/06/12	SHEET	1/2	PH2.54 SINGLE ROW DOUBLE PLASTIC 90° MIDDLE BENDING H=2.5
REV	DATE	MODIFICATION DESCRIPTION	CHANGE	Angle ± 3°	APPROVE	DATE	PROJ.		Customer NO.
				DIM TOL	Steven Zhao	2025/06/12			

WCON
Http: www.wcon.com

WCON-Dongguan
Tel: +86 769 85358920
Fax: +86 769 85358915
E-mail: sales@wcon.com

WCON-Kunshan
Tel: +86 512 57468408
Fax: +86 512 57468468
E-mail: salesks@wcon.com

HSF

Packing:

Packaging Quantity Refers To The Following Table

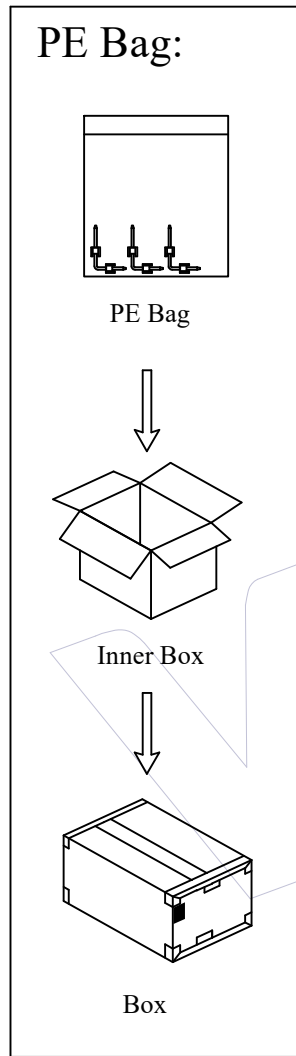

PINS	Q' ty/Bag (16.0<L≤19.0)	PINS	Q' ty/Bag (16.0<L≤19.0)
1	1,000	21	100
2	1,000	22	100
3	800	23	100
4	800	24	100
5	800	25	100
6	500	26	100
7	500	27	100
8	500	28	100
9	500	29	100
10	300	30	100
11	300	31	100
12	300	32	100
13	300	33	100
14	200	34	100
15	200	35	100
16	200	36	100
17	200	37	100
18	200	38	100
19	200	39	100
20	100	40	100

A3	2025/06/12	Standardization Drawing	CP	OPERATION	DRAW	DATE	SCALE	Fit	PART NO.
A3	2025/03/18	Modify	DuYing	x.X ±0.40	CP	2025/06/12	UNIT	mm	1125-21XXXXRXXXCXXX $\triangle A_2$
A2	2018/06/02	Cancel PBT & Modify P/N	XSR	x.XX ±0.25	CHECK	DATE	SIZE	A4	TITLE:
A0	2012/05/17	NEW	William Chen	x.XXX ±0.15	TANG	2025/06/12	SHEET	2/2	PH2.54 SINGLE ROW DOUBLE PLASTIC 90° MIDDLE BENDING H=2.5
REV	DATE	MODIFICATION DESCRIPTION	CHANGE	Angle ± 3°	APPROVE	DATE	PROJ.		Customer NO.
				DIM TOL	Steven Zhao	2025/06/12			

WCON
Http: www.wcon.com

WCON-Dongguan Tel: +86 769 85358920 Fax: +86 769 85358915 E-mail: sales@wcon.com

WCON-Kunshan Tel: +86 512 57468408 Fax: +86 512 57468468 E-mail: salesks@wcon.com